

02

owner's manual Carmela24
unboxing & assembly



Model: Carmela24

According to EN ISO 4210-2/2015 and

EN 15194/2018.



oh!bike factoria S.L.

B66493271

Diputació 286, Baixos

08009 Barcelona

info@carmelabikes.com

unboxing & assembly

Your Carmela24 has been assembled with love in Barcelona. However, to for improved safety transportation, some components must be assembled later.

This assembly is not difficult, but it must be done with caution and care since an incorrect assembly can result in the damage of the bi-cycle.

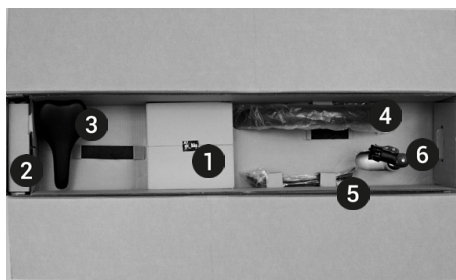

1

Check the contents of the box.

- | | |
|------------|-------------|
| ① Tool kit | ④ Fende |
| ② Battery | ⑤ Kickstand |
| ③ Seat | ⑥ Carmela24 |

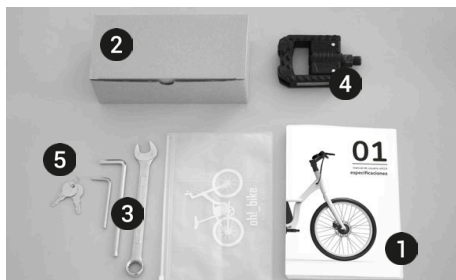

2

Check the content of the Tool kit.

- | | |
|-----------|----------------|
| ① Manuals | ④ Pedal |
| ② Charger | ⑤ Battery keys |
| ③ Tool | |

Fixed M15, Allen M4, Allen M6



3

Before removing the cardboard tray, remove all the components.



Be especially careful with the battery, as it can be damaged if it falls on the ground.

**4**

Take out the frame, which has the front wheel and the handlebar are fixed to it. Use the packaging cartons **1** to hold the bike.

**5**

Remove all the white flanges and the protective plastics.

 Do not remove the plastic from the fork **1** so as not to damage it during assembly.

**6**

Place the fork in its correct position. The brake should be on the inside of the bicycle and the stem on the outside, to be able to place the handlebar.

 It is important that the cables do not twist or bend.

**7**

Unscrew the screws of the stem's cover. Use the 4mm Allen wrench.



8

Remove the cover.



9

Mount the handlebar centered in the tightening area. Look at the handlebar marks.

⚠ Screw the screws of the handlebar clamp a couple of turns with your fingers.



10

⚠ Make sure the cables do not twist or bend. Do not squeeze the brake levers if the wheel is not in place.

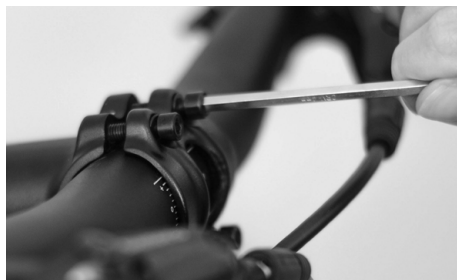

11

⚠ Tighten the screws evenly and crosswise. Make sure you have tightened enough so that the handlebar is properly fixed to the stem.

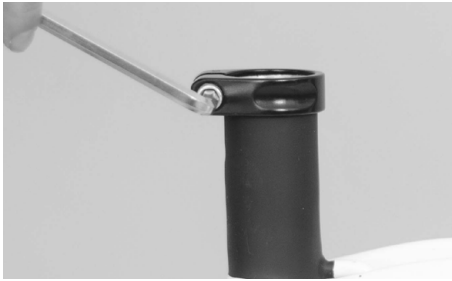

12

Unscrew the fixing screw of the seat post clamp with the 6 mm Allen key.



13

Insert the seat post into the seat tube. It is recommended to use mounting paste



14

Align the saddle, place it to your size, and tighten the screw. Make sure that the seat does not rotate and is well fixed in its position.



15

⚠ Before mounting the pedal. Check that the letter "R" that designates the right pedal is marked.



16

Screw the pedal onto the connecting rod thread with your hand, giving two or three turns. Clockwise. It is recommended to use mounting paste.



17

Use the 15mm fixed wrench to finish screwing in the pedal completely.

 Make sure it is firmly fixed.



18

Carefully rotate the bicycle by resting it on the saddle and handlebar.

 Pay attention not to damage the bell, boost button or brake wiring.



19

Remove the protectors from the fork.

 If you have also purchased fenders, you must assemble them before placing the wheel.

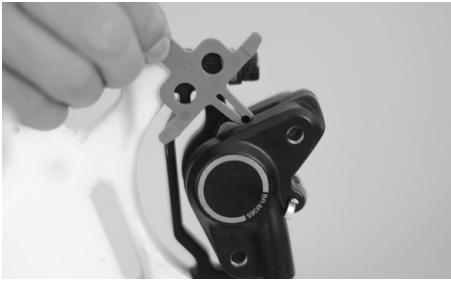

20

Prepare the front wheel: remove the brake pad spacer.

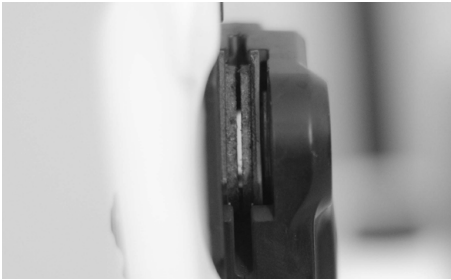

21

Check that the pads are placed exactly in their seats in the brake caliper. The slot between the pads needs to be parallel.

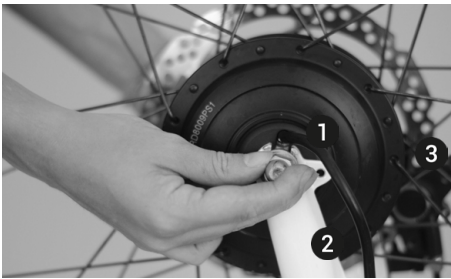

22

⚠ Place the wheel. Screw a couple of turns with your fingers ❶. Check that it fits on the dropouts. That is centered on the fork ❷ and that the disc brake is placed between the pads ❸.



23

Once the wheel is installed, you must connect the motor cable. To do this, first remove the two lower cable clamps from the fork. You can do it with your hands or with help from a flathead screwdriver.

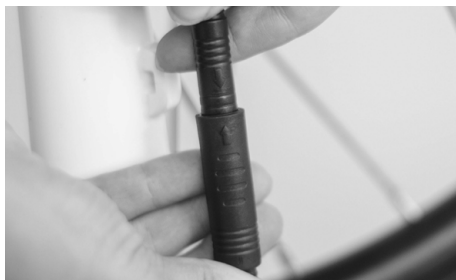

24

- ⚠ Connect the motor, in the position indicated by the arrow on the connector.



25

- Replace the cable clamps with the motor cable properly fastened.



26

- Turn the bicycle over on the wheels and tighten the wheel tightening nuts with the 15mm wrench.

- ⚠ Make sure the wheel is fixed to the fork.

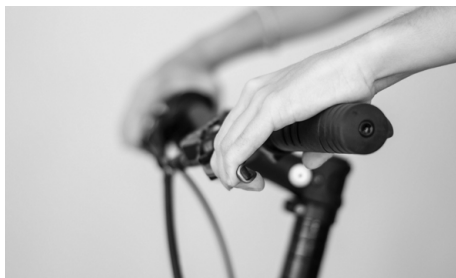

27

- Operate the brake lever several times after mounting the wheel.



28

Lift the bicycle and spin the wheel.

- ⚠ The brake disc should not rub against the pads when you do not operate the brake lever. If you tap against the pads, check **maintenance**.



29

Finally, raise the wheel again a few centimeters from the ground and lightly hit the tire from above. If the wheel is secure, it will remain in the fork tips and will not make a noise.



30

- ⚠ Insert the key into the lock, with the teeth facing the front of the bike. ① Make sure that the lock latch is in the open position. ② Insert the battery between the two top tubes ③.



31

Connect the front rubber buffer ① and accompany the battery towards the connector ②.

- ⚠ Make sure you hear the "click" of the lock ③.



32

You have just assembled your oh!bike! If you have to mount an accessory, check **accessories**. Before starting the electrical system, and before using the bicycle, read **check & use**.



33

What should you do with the packaging once the oh!bike is assembled? After the 15-day trial period, you can recycle the packaging according to the recycling criteria established in your geographical area

02

unboxing & assembly



EN 1811 edition - oh!bike factoria S.L